

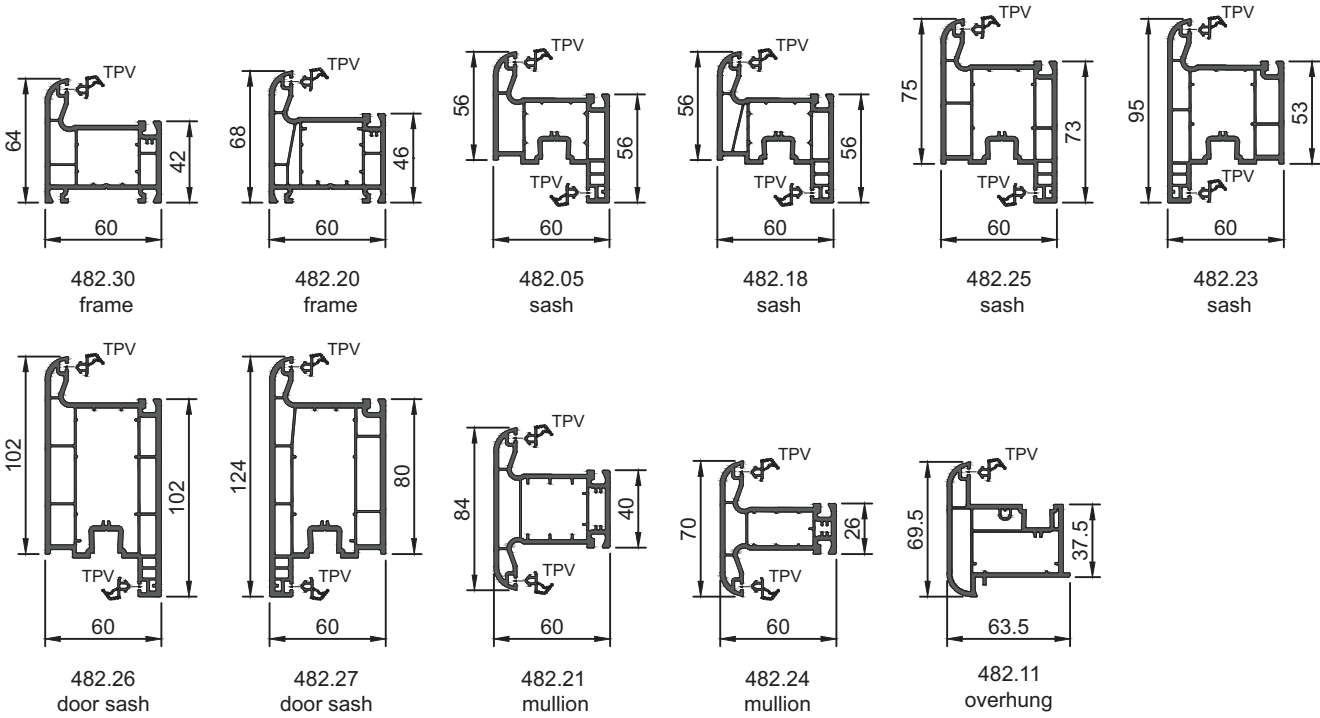

PVC PROFILES SYSTEMS



Main profiles



Glass beads

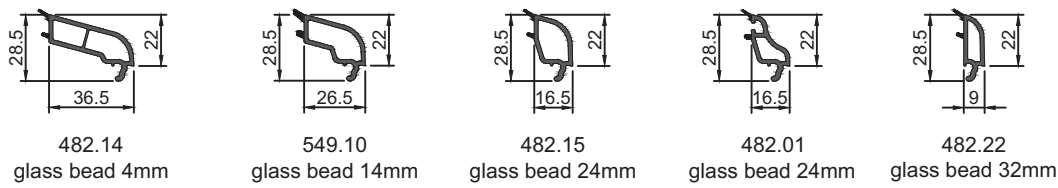

Additional profiles

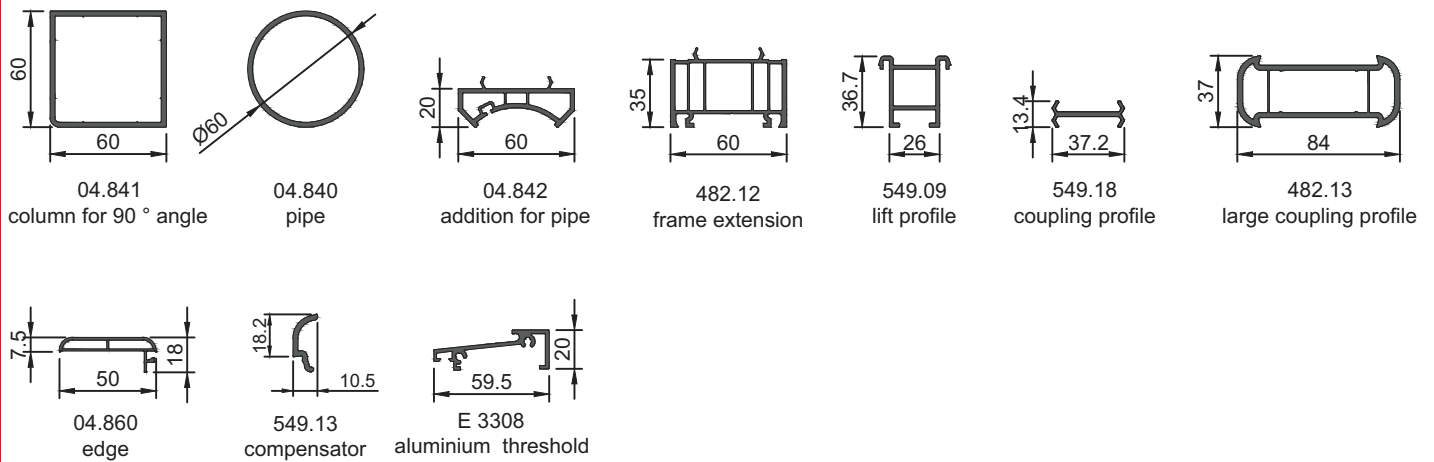

EPDM gaskets



PVC panels and sills

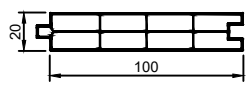

04.844
PVC panel

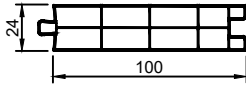

04.843
PVC panel

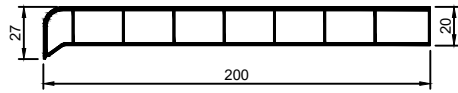

04.846
sill

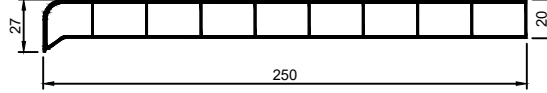

04.847
sill

Reinforcements

For:
482.05
482.18
482.20
482.30

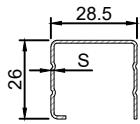

TRE 01-01K
S=1.0mm

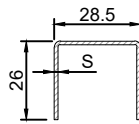

TRE 01
S=0.8mm
S=1.2mm
S=1.5mm
S=2.0mm

For:
482.21

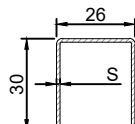

TRE 02-60
S=1.2mm

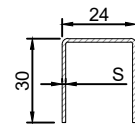

TRE 02
S=1.0mm
S=1.2mm
S=1.5mm
S=2.0mm

For:
482.26
482.27

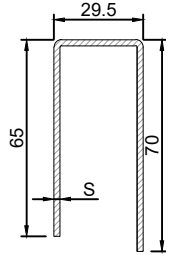

TRE 03
S=2.0mm

For:
04.841

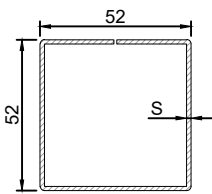

TRE 06
S=1.5mm

For:
482.24

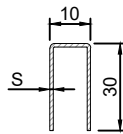

TRE 08
S=1.2mm

For:
04.840

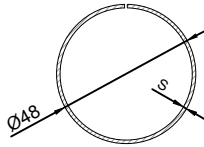

TRE 10
S=1.2mm

For:
482.13

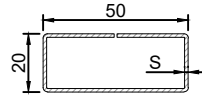

TRE 12
S=1.2mm

For:
482.20
482.30

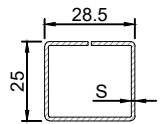

TRE 13
S=1.2mm

For:
482.21

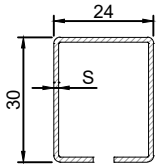

TRE 14
S=1.2mm

For:
482.23
482.25

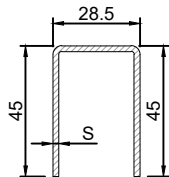

TRE 16
S=1.5mm
S=2.0mm

For:
482.11

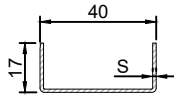

TRE 17
S=1.2mm

For:
482.21

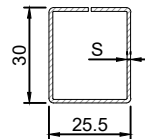

TRE 19
S=1.2mm

Accessories

KM242

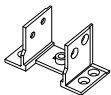

mullion
connector
for 482.21

KM241



mullion
connector
for 482.24

KM344

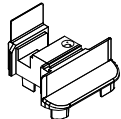

end cover cap
for
overhung 482.11

KM530

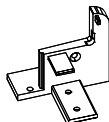

end cap
for
treshold 60mm

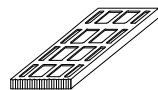

AP3220;AP3230;
AP3240;AP3250;
glazing spacer

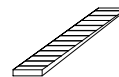

AP3320;AP3324;
AP3326;AP3330;AP3332;
bridge

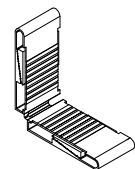

AP3170;AP3174;AP3172;
angle

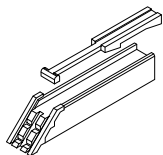

AP3175
angle joint for
sash 482.23 and 482.25

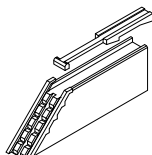

AP3174
angle joint for
door sash 482.26 and 482.27

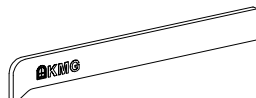

cover cap for sill 04.846- 200mm

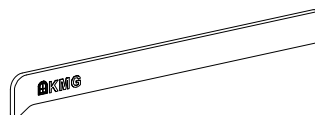

cover cap for sill 04.847- 250mm

Main profiles

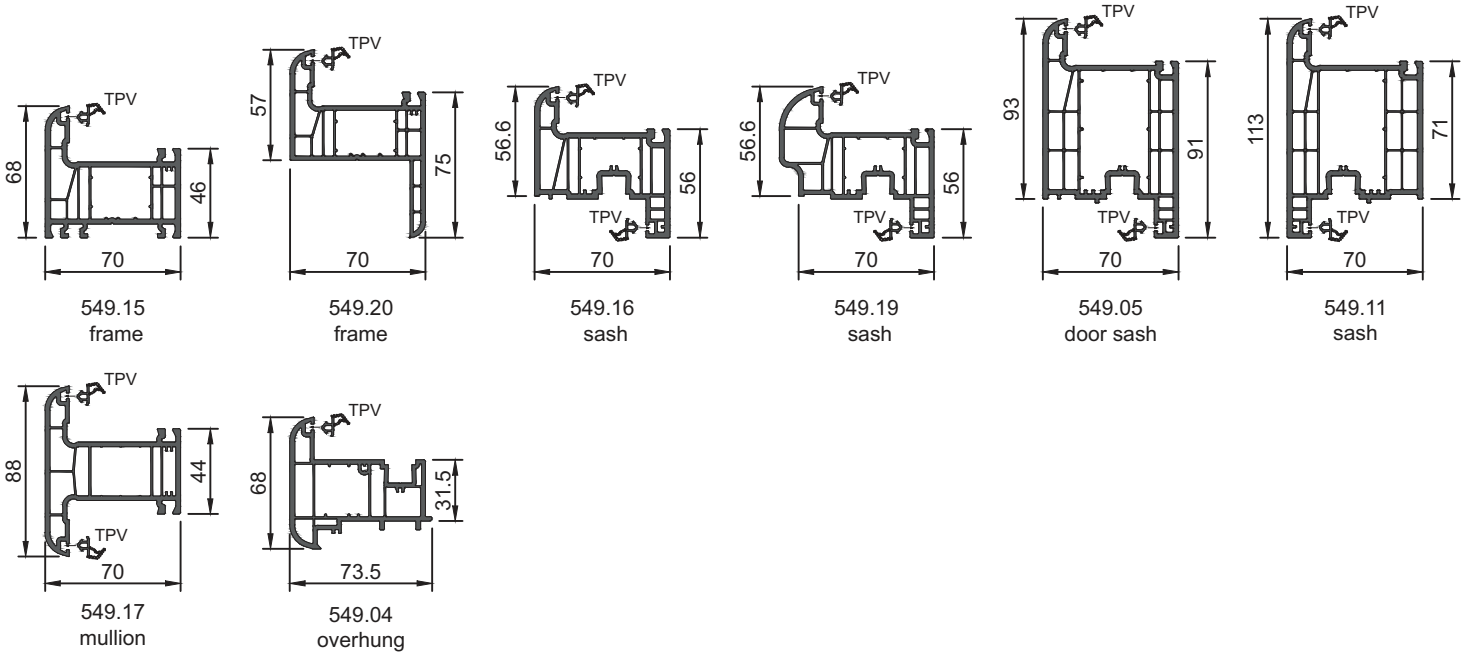

PRESTIGE PLUS

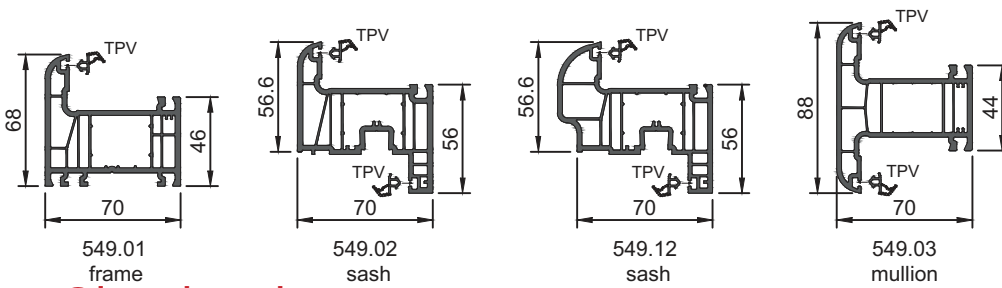

Glass beads

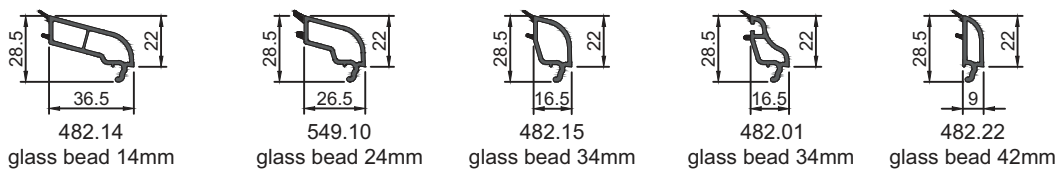

Additional profiles

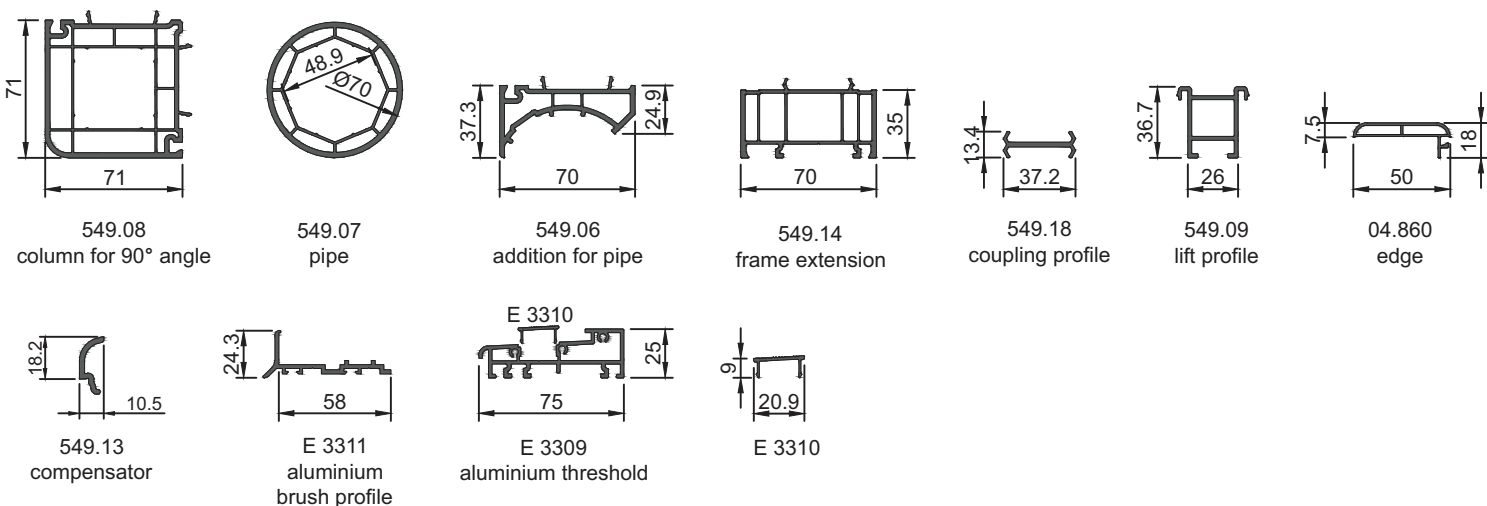

EPDM gaskets



PVC panels and sills

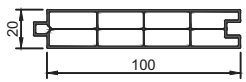

04.844
PVC panel

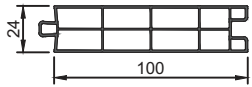

04.843
PVC panel

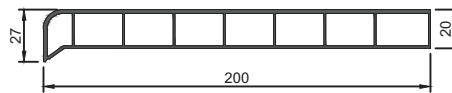

04.846
sill

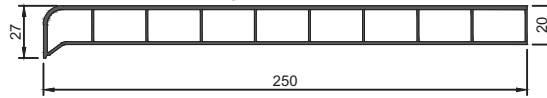

04.847
sill

Reinforcements

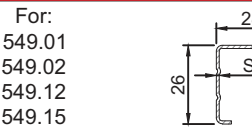

TRE 01
S=1.0mm

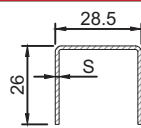

TRE 01
S=0.8mm
S=1.2mm
S=1.5mm
S=2.0mm

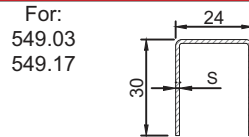

TRE 02-70
S=1.2mm
S=1.5mm
S=2.0mm

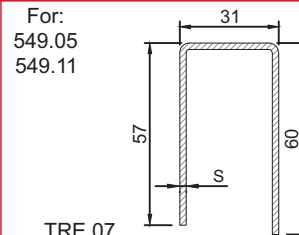

TRE 07
S=2.0mm

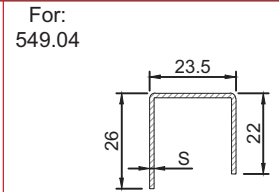

TRE 09
S=1.5mm

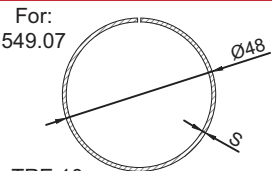

TRE 10
S=1.2mm

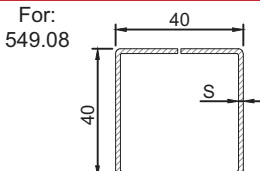

TRE 11
S=1.5mm

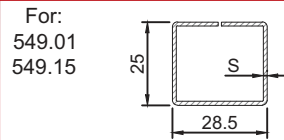

TRE 13
S=1.2mm

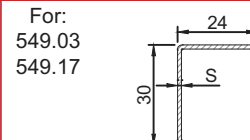

TRE 14
S=1.2mm

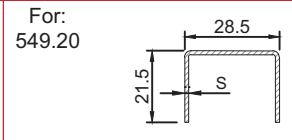

TRE 18
S=1.2mm
S=1.5mm

Accessories

KM251

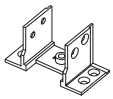

mullion connector
(549.17;549.03)
frame

KM250



mullion connector
(549.17;549.03)
sash

KM510

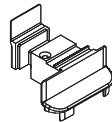

end cover cap for
overhung (549.04)

KM520

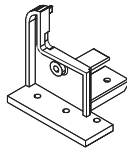

end cap for
door sill 70mm

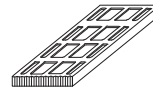

AP3220;AP3230;
AP3240;AP3250;
glazing spacer

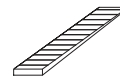

AP3320;AP3324;
AP3326;AP3330;AP3332;

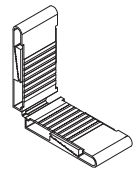

AP3170;AP3174;AP3172;
angle

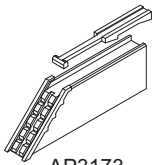

AP3173

angle joint for

door sash 549.05 and 549.11

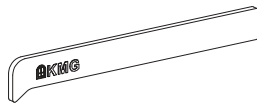

cover cap for sill 04.846- 200mm

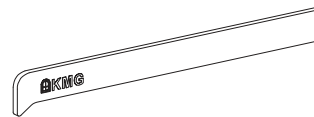

cover cap for sill 04.847- 250mm

Aluminium cover caps

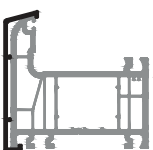

3315
331 gr/m
Al cover cap
frame

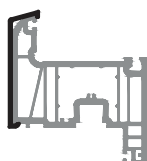

3312
260 gr/m
Al cover cap
sash

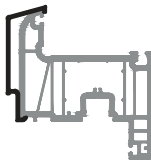

3313
300 gr/m
Al cover cap
sash

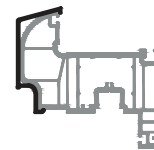

3314
317 gr/m
Al cover cap
sash

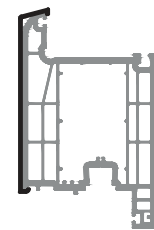

3318
385 gr/m
Al cover cap
door sash

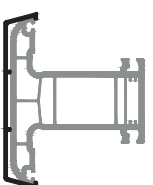

3316
416 gr/m
Al cover cap
mullion

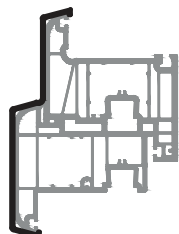

3319
507 gr/m
Al cover cap
sash-overhung



Address:
8000 Burgas
South Industrial Zone, Bulgaria

Tel: +359 56 880 440
Fax: +359 56 880 443
office@altest-kmg.com

www.altest-kmg.com